

BV-3X7-C

1/3" CCD B/W Camera

Very Hi-sensitivity & Switching Power Supply (DC12~AC24V / AC90~260V)

- 1/3" Sony SuperHAD CCD Sensor
- Auto Gain Control
- Backlight Compensation (BLC)
- C or CS Lens Mount
- Link Lock - AC only
- Minimum Illumination - 0.044 Lux



Model Number	BV-357-C	BV-367-C
Image area	4.9mm x 3.7mm	
Image sensor	1/3" Super-HAD CCD 752(H) X 582(V)	1/3" Super-HAD CCD 500(H) X 582(V)
TV system	2:1 Interlace CCIR ; V:50Hz,H:15.625KHz	
Horizontal resolution	600 TV lines or more	400 TV lines or more
Synchronization	DC power : Internal AC power : Internal / Linelock switchable	
Linelock V-phase compensation	External VR with 0~300 degree 0.45 fixed	
AGC	Average AGC On/Off switchable	
Minimum Illumination	0.044 lux (F1.2, 3200K) ;50 IRE, AGC ON	
S/N ratio	More than 50dB	
Backlight compensation	On/Off switchable for AES/AI/AI-AMP mode	
Power Supply	DC12V~AC24V +/- 10% / 50Hz +/- 1Hz or AC90V~260V / 50Hz +/- 1Hz	
Lens mount	C/CS-mount	
Video output	VBS 1 BNC (75 ohm)	
Shutter control	Auto 1/50~1/100,000 sec.	
Iris control	Video out driver/ DC iris driver	
Aperture	Horizontal/Vertical Direction(3D)	
Emission& safety standard	CE , LVD	
Accessories	Instruction manual, IRIS 4 pins plug	
EE Lens	4pin connector DC/Video driver (S/W)	
Tripod mount hole	Provided (Top & Bottom)	
Power consumption	4 W (max.)with AI lens	
Dimensions	60(W) X 50(H) X110 (L)	
Ambient temperature	30%~90 % RH / -10~+50 degree C.	
Weight	450g	

Rear Panel Indication

Model No. BV-357-C & BV-367-C

DC12~AC24V

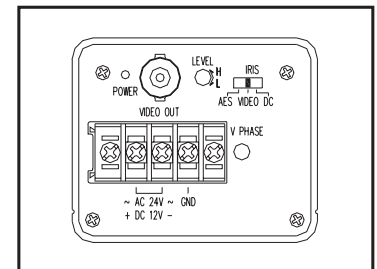

AC90~260V

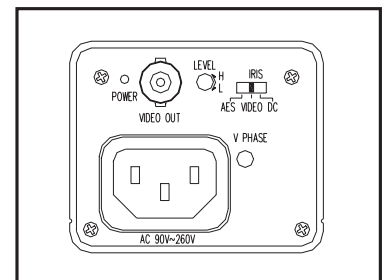

*** Design and specifications are subject to change without notice ***

